



# Plagiarism and AI Detection Platform Brightspace Instructor Guide

D2L  
BRIGHTSPACE

# Welcome to Copyleaks for Brightspace.

This guide will give you a general overview of what you need to start using Copyleaks in Brightspace, including how to create assignments plus how to interpret your Similarity Report.

This guide also covers the AI Content Detector, a built-in feature that allows you to scan for AI-generated content alongside plagiarism.

Other portions of this guide cover general information, including scan settings, understanding the different alerts, and troubleshooting tips.

Please contact your institution's Brightspace administrator for any questions not covered in this guide.

## Table of Contents

**Getting Started** ..... [Page 3](#)

**Plagiarism Detection** ..... [Page 4](#)

**AI Content Detector** ..... [Page 5](#)

**Scan Settings** ..... [Page 6](#)

**Troubleshooting** ..... [Page 7](#)

# Getting Started

Find essential information about creating and viewing assignments, understanding the Similarity Report following a scan, and accessing the Instructor Plagiarism + AI Scan Tool.

[Creating Copyleaks Assignments](#)  
[Interpreting the Similarity Report](#)

## Accessing & Using the Instructor Plagiarism + AI Scan Tool

The Instructor Plagiarism + AI Scan Tool enables instructors to scan files or copy and pasted content for plagiarism outside of an assignment. The tool is helpful for late submissions, non-assignment modules such as discussion board posts, and your own class materials. Below the upload window, instructors can view the similarity score of their uploads at a glance and view the interactive report by simply clicking on the score.

To add the tool to a course select Existing Activities, then choose LTI 1.3 Teacher Scanning Tool (or whatever the tool has been named by your admin):

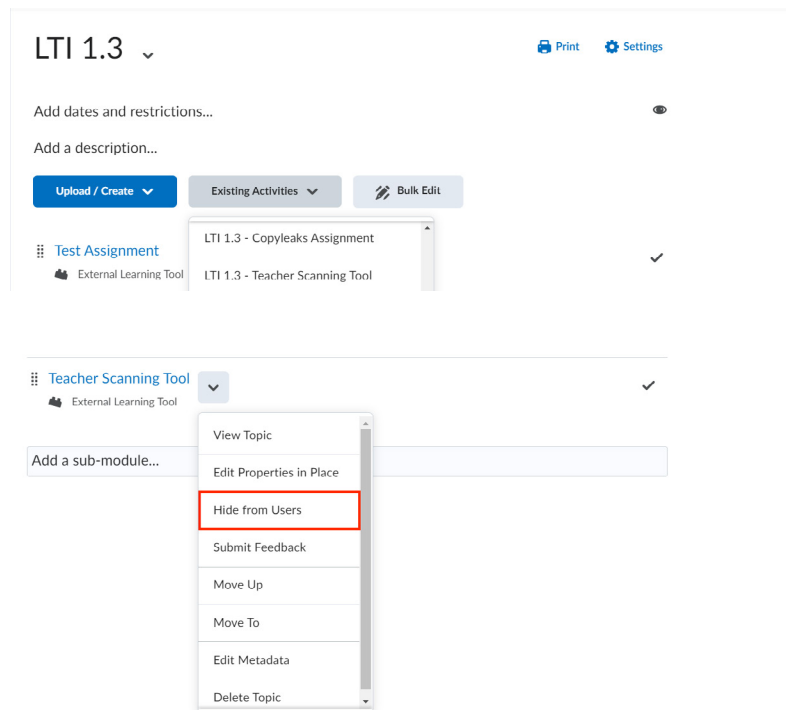

Next, you will see the tool appear in the module. Students won't be able to access the tool but to avoid any confusion we recommend hiding the tool. This can be done by clicking the down arrow next to the tool then selecting Hide from Users.

For more information on how to use Instructor Plagiarism + AI Scan Tool see our page [here](#).

# Plagiarism Detection

## Similarity Levels

Copleaks detects multiple forms of plagiarism, including many forms of paraphrasing. In your Similarity Report, you can see results for the following:

- Identical Text
- Minor Changes
- Paraphrasing
- Omitted Words

[Learn more](#)

## The Copleaks Internal Database

Our Internal Database is a shared hub for Copleaks institutions that contains millions of user-submitted documents, including student assignments. You can compare files to content within the Internal Database to check against work from past semesters.

[Learn more](#)

## Duplicate Assignment Reminder

If an assignment has multiple attempts enabled, subsequent submissions from a single student to the same assignment will be ignored to avoid false flags against the student's previous submission. However, a result from the Internal Database will appear if the same paper is submitted to a different assignment.

## Character Manipulation

Another detection alert you may see on your Similarity Report is for manipulated characters.

### This can include:

- Special Characters
- Character Replacement
- White Characters

[Learn more](#)

# AI Content Detector

The Copyleaks AI Content Detector is the most comprehensive and accurate AI text detection solution available, with 99.1% accuracy and a 0.2% false positive rate, the lowest of any platform, built right in and accessible through the scan settings.

## What models can you detect?

As of April 1st, 2024 our AI Content Detector can detect content created by most AI text generators and text bots including the GPT4 model, ChatGPT, Bloom, Jaspr, Rytr, and more.

## What languages do you support?

The AI Content Detector offers more language options than any other solution on the market, including English, Spanish, French, Portuguese, German, Italian, Russian, Polish, Romanian, Dutch, Swedish, Czech, Norwegian, Korean, Japanese, and Chinese (Simplified and Traditional), and more. For a full list of supported languages, [click here](#).

For further questions about our AI Content Detector, please visit our [FAQ Guide](#).

# Scan Settings

## Template Exclusion

Teachers can upload templates to exclude specific text when running a scan on a student’s assignment, preventing similar content detection regarding original questions, prompts, and more.

[Learn more](#)

## Admin Lock

Settings with a lock icon next to them have been locked by your institution’s administrator and cannot be changed at the assignment level. If there is a setting you need to change that has been locked, please contact your Brightspace administrator.

## Show Student Information

If your admin has enabled this setting, you can see the date and time of submission along with the user (via their email or username) who submitted the detected result.

## Writing Assistant

Keep your writing concise and accurate with grammar, spelling and sentence structure tips that help prevent run-ons, fragments, and more. Plus, word choice suggestions align your vocabulary with the intended audience and identify potentially misused words and homophones.

If you are interested in hearing more about this feature and how you could use it at your institution please contact your admin.

[Learn more](#)

## Cross-Language Detection

This enables you to scan for results in over 30 languages from which content may have been taken. For example, a document in French can be scanned to see if it matches results translated from another language, such as Spanish.\*

[Learn more](#)

*\*Note: Additional costs apply; contact your Admin to have this feature added.*

Categorized Summary

- Grammar** 3 CORRECTIONS ^
  - Verb Form (1)
  - Preposition (1)
  - Pronoun (1)
- Mechanics** 3 CORRECTIONS ^
  - Comma (2)
  - Spelling (1)
- Sentence Structure** 2 CORRECTIONS ^
  - Fused Sentence (1)
  - Missing Words (1)

Chronological

- London** → **London) was a** ⋮
  - Missing Words
  - Identifies sentences that are missing essential words, resulting in incomplete or unclear meaning.
- forces** → **forced** ⋮
  - Verb Form
  - Using an incorrect form of a verb (such as tense, aspect, or

# Troubleshooting

If you are experiencing a technical issue, we suggest using Google Chrome as your default browser and clearing your browser's cache.

## [Learn more](#)

To ensure third-party cookies are enabled Chrome:

1. Click on Settings
2. Navigate to Privacy and security
3. Click Third-party cookies
4. Allow third-party cookies

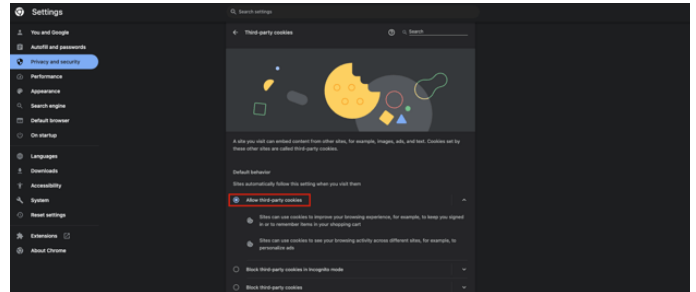

However, if the problem persists, please contact your institution's Brightspace administrator. If they cannot resolve the issue, they will contact your institution's Account Manager, who will help promptly resolve it.

For further questions regarding Copyleaks and your Brightspace LMS integration with Copyleaks, please visit our [Help Center](#).



**Building digital trust and confidence:  
It's the Copyleaks way.**

[help.copyleaks.com](https://help.copyleaks.com)



[copyleaks.com](https://copyleaks.com)